

PSE 34_-14 with brushless DC motor

Positioning of auxiliary and positioning axes



Special features

- complete solution including motor, gear, controller, absolute measuring system and bus interface
- easy mounting due to hollow shaft, manual positioning also possible
- quickly recoups automation costs by considerably reducing setup time
- eliminates the need for reference runs
- jog key operation for manual positioning without engaging the external control module (optional)
- address may be set using the BUS or a manual decade switch, (Sercos III / EtherCat optional)
- optional brake for raising holding torque

nominal power output	100 W
start-up duration	20 % (basis time 300 s)
supply voltage	24 VDC ± 10 % galvanic separation between control unit and motor
nominal current	7,8 A
power consumption (control unit)	0.1 A
positioning accuracy position data are acquired directly at the output shaft	0.9 °
positioning range	256 rotations, no mechanical limits
shock resistance as stipulated in DIN IEC 68-2-27	50 g 11 ms
resistance to vibration as stipulated in DIN IEC 68-2-6	10...55 Hz 1.5 mm / 55...1000 Hz 10 g / 10...2000 Hz 5 g
testing	CE
output shaft	14 H7 hollow shaft with clamp and feather key
maximum axial thrust	20 N
maximum radial force	40 N
ambient temperature	0...45 °C
storage temperature	-10...70 °C
protection class	IP 54
weight	1900 g

Technical data

nominal power	nominal torque	self-holding torque	nominal rated speed	model
100 W	10 Nm	5 Nm	80 min ⁻¹	A 3410-14
100 W	18 Nm	9 Nm	60 min ⁻¹	3418-14

data interface	Bus cable may be looped through (optional)	model
CANopen / DS 301		B C
Profibus DP (switchable bus terminator)		DP
DeviceNet		DN
Sercos III		S3
EtherCat		EC

instrument connections *not for Sercos III / EtherCat / CANopen	model
Standard (round socket for bus, blade terminal for power supply)	C S
Standard + 2nd connection for data bus (data bus looped through)	B
Standard + connection to jog keys for manual operation*	T
Standard + connection to jog keys for manual operation + 2nd connection to data bus*	TB

optional hand brake	model
no brake	D O
with brake (holding torque is equivalent to nominal torque)	M

optional address switch Sercos III / EtherCat	model
no address switch	E OA
with address switch	MA

Order key

	A	B	C	D	E
PSE	-	-	-	-	-

accessories (connectors) 9601-xxxx	C/DP	DN	S3/EC
<input type="checkbox"/> Standard (connector for bus and power supply)	-0059	-0087	-
<input type="checkbox"/> Standard + 2nd data bus connector	-0060	-0088	-0112
<input type="checkbox"/> Standard + jog key connector	-0061	-0089	-
<input type="checkbox"/> Standard + 2nd data bus connector + jog key connector	-0062	-0090	-

PSE 34_-14 with brushless DC motor

Dimension drawing

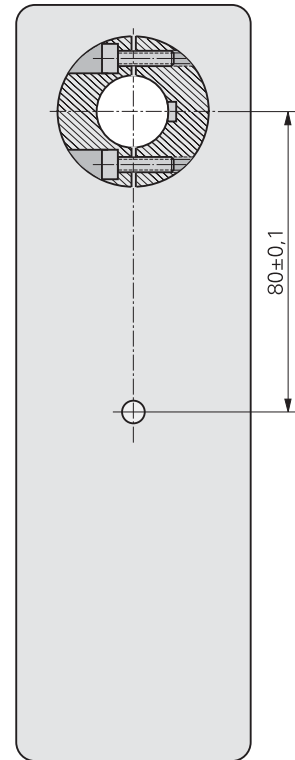
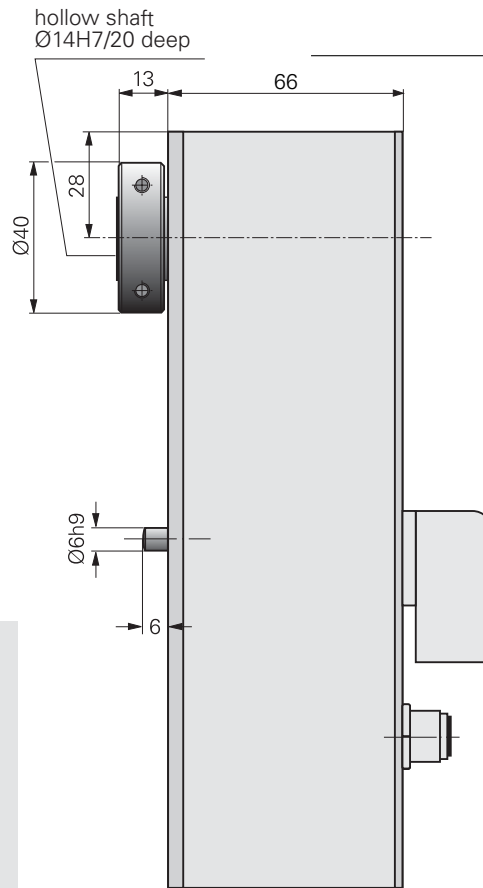
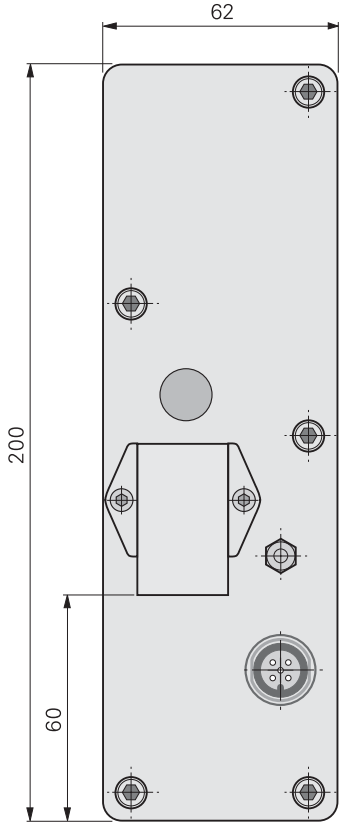

Characteristic line



Connection diagram

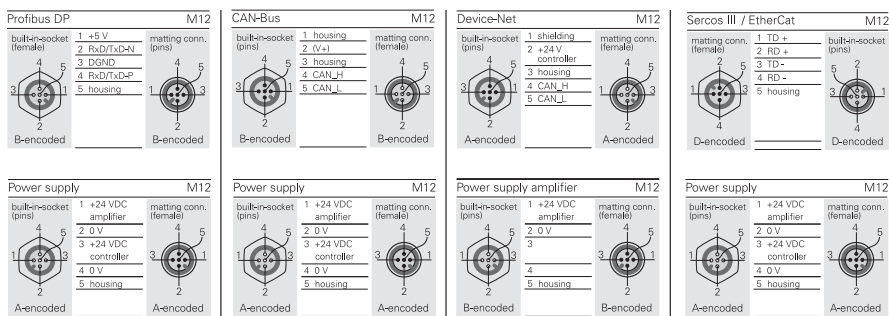

Functional block diagram

