

PSE 36_/38_-14 in stainless steel housing with brushless DC motor

Positioning of auxiliary and positioning axes



Special features

- complete solution including motor, gear, controller, absolute measuring system and bus interface
- quickly recoups automation costs by considerably reducing setup time
- eliminates the need for reference runs
- address may be set using the BUS or a manual decade switch (optional)
- bus cable may be looped through
- optional latch brake for raising holding torque
- V4A design for housing

| | |
|---|---|
| nominal power output | PSE 36_: 20 W, PSE 38_: 35 W |
| start-up duration | 30 % (basis time 300 s) |
| supply voltage | 24 VDC ± 10 % galvanic separation between control unit and motor |
| nominal current | PSE 36_: 2 A, PSE 38_: 3 A |
| power consumption (control unit) | 0.1 A |
| positioning accuracy | 0.9 ° |
| position data are acquired directly at the output shaft | |
| positioning range | 256 rotations, no mechanical limits |
| shock resistance as stipulated in DIN IEC 68-2-27 | 50 g 11 ms |
| resistance to vibration as stipulated in DIN IEC 68-2-6 | 10...55 Hz 1.5 mm / 55...1000 Hz 10 g / 10...2000 Hz 5 g |
| testing | CE |
| output shaft | external square 10 mm or 14 H7 hollow shaft with adjustable collar |
| maximum axial thrust | 20 N |
| maximum radial force | 40 N |
| ambient temperature | 0...45 °C |
| storage temperature | -10...70 °C |
| protection class | IP 67 when in operation IP 68 when not in operation |
| V4A design for housing | |
| weight | 1800 g |

Technical data

| nominal power | nominal torque | self-holding torque | nominal rated speed | A model |
|---|----------------|---------------------|-----------------------|-------------------|
| 20 W | 1 Nm | 0.5 Nm | 180 min ⁻¹ | 361-14 |
| 20 W | 2 Nm | 1 Nm | 100 min ⁻¹ | 362-14 |
| 20 W | 5 Nm | 2.5 Nm | 35 min ⁻¹ | 365-14 |
| 35 W | 2 Nm | 1 Nm | 125 min ⁻¹ | 382-14 |
| 35 W | 5 Nm | 2.5 Nm | 50 min ⁻¹ | 385-14 |
| data interface | | | | B |
| CANopen / DS 301 | | | | C |
| Profibus DP (switchable bus terminator) | | | | DP |
| DeviceNet | | | | DN |
| Sercos III | | | | S3 |
| EtherCat | | | | EC |
| Bus cable may be looped through optional address switch | | | | C |
| no address switch | | | | O |
| with address switch | | | | A |
| output shaft | | | | D |
| external square, 10 mm | | | | V |
| 14 H7 hollow shaft with adjustable collar | | | | H |
| optional hand brake | | | | E |
| no brake | | | | O |
| with brake (holding torque is equivalent to nominal torque) | | | | M |
| instrument connections | | | | |
| round socket for power supply and bus + 2nd connection for data bus | | | | |

Order key

| | | | | | | | | | | |
|--|---|----------|---|----------|---|----------|---|----------|---|------------------|
| PSE | - | A | - | B | - | C | - | D | - | E |
| accessories (connectors) | | | | | | | | | | |
| <input type="checkbox"/> Standard (connector for bus and power supply) | | | | | | | | | | 9601-0076 |
| <input type="checkbox"/> Standard + 2nd data bus connector | | | | | | | | | | 9601-0077 |

PSE 36_/38_-14 in stainless steel housing with brushless DC motor

Dimension drawing

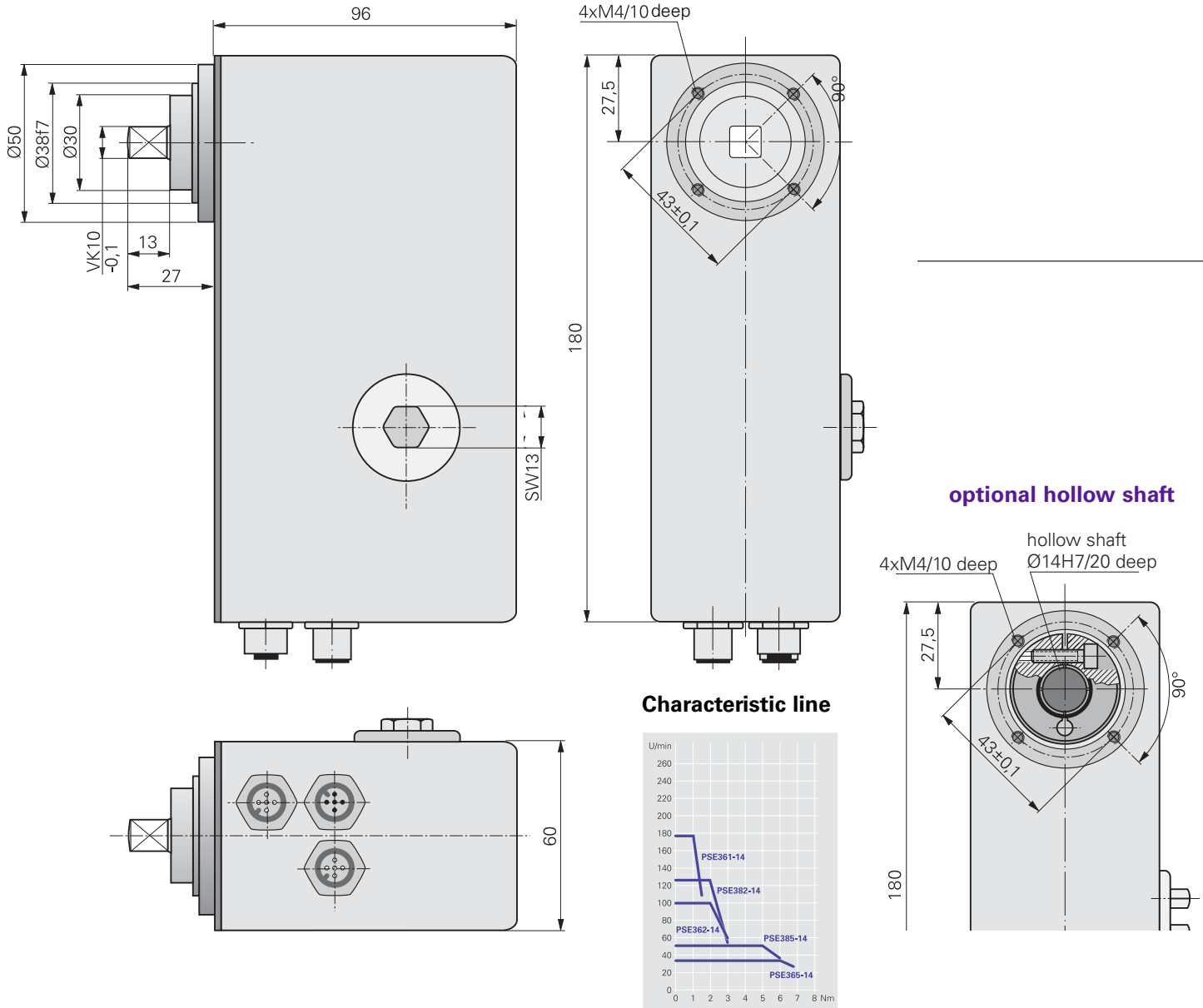

optional hollow shaft

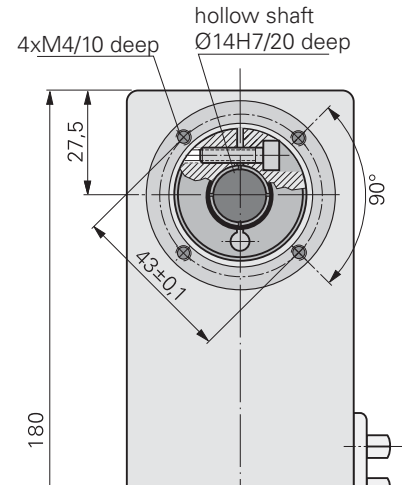

Connection diagram

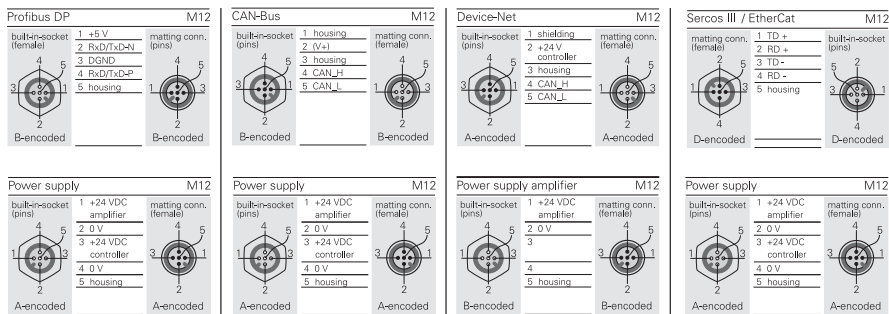

Functional block diagram

